

PTF60290 series cabinet top ventilator

600x600x290mm | 2500-3150 m³/h

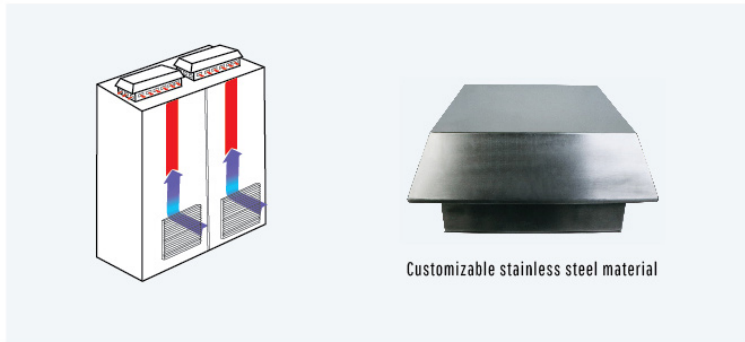

Colour	RAL7035,color can be customized
Protection category	IP54 standard, IP55 plus precision filter mat, IP56 plus precision filter mat and protective cover.



Dimensions

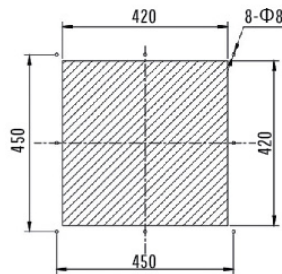
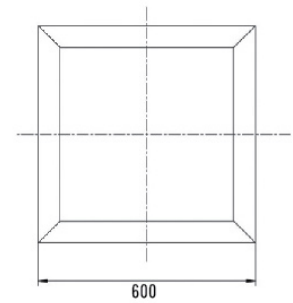
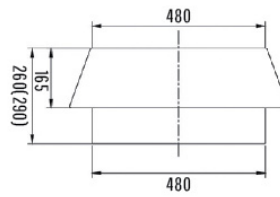

hole size

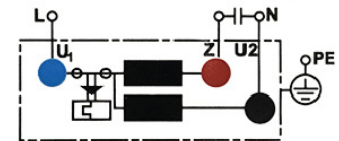

Electrical wiring diagram

Installation conditions:

- The ambient temperature should be lower than the required temperature in the control cabinet.
- When the space in the cabinet is insufficient to install the side-mounted filter fan, the top-mounted fan can be considered.
- The fan on the top of the cabinet protects the electrical components of the cabinet by pumping hot air from the top of the control cabinet and dispersing the heat inside the cabinet out of the cabinet.
- The use of centrifugal fan can not only avoid the eddy current caused by the discharge of ordinary shielded pole fan, but also reduce the noise caused by air friction.



Model No.	unit	PTF60260	PTF60290
Rated operating voltage,frequency	V/Hz	230, 50	230, 50
Air flow	m ³ /h	2500	3150
Rated current max.	A	0.80-1.20	1.18
Centrifugal fan		Capacitor start	Capacitor start
Rated Power	W	180-270	180-270
Noise level	dB(A)	66-68	70
Operating temperature range	℃	-25-+60	-25-+60
Dimensions	mm	600x260x600	600x290x600
Fans dimensions	mm	Φ 355	Φ 400
Mounting section size	mm	420x420	450x450

REF600 series cabinet top ventilator

350x350x148mm | 415-500 m³/h



Colour	RAL7035, color can be customized
Protection category	IP54 standard, IP55 plus precision filter mat, IP56 plus precision filter mat and protective cover.

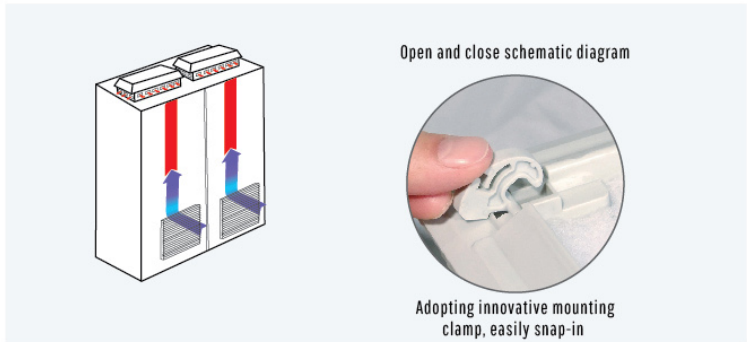

Features:

- Easy and fast snap in mounting that does not require screw
- Adjustable mounting clamps fit for different cabinet thickness range from 1.5 to 3.5mm
- IP54 protection, G3 standard filter pad
- Tool-less and quick replacement of the filter pad, just turn the button on the top
- The standard color is RAL7035, other colors as per request.
- AC voltages as standard type, DC voltages could be offered



Dimensions

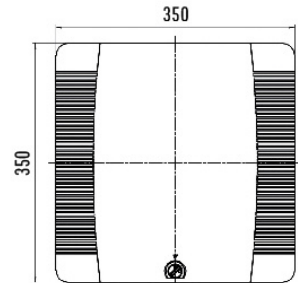
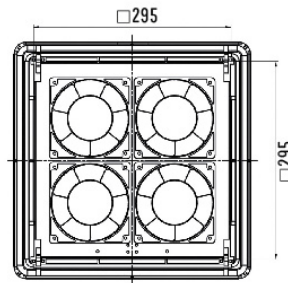
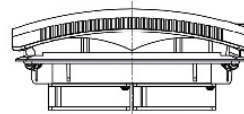
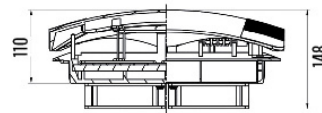

Model No.	unit	REF600.230	REF600.115	REF600.024
Rated operating voltage, frequency	V/Hz	230, 50/60	115, 50/60	24V (DC)
Air flow	m ³ /h	50/60	50/60	
Rated current max.	A	415-500	415-500	430-500
Centrifugal fan		0.14-0.1	0.24-0.18	0.28-0.35
Rated Power	W	19-14	19-14	7.7
Noise level	dB(A)	46-48	46-48	47-49
Operating temperature range	°C	-30-+70	-30-+70	-30-+70
Dimensions	mm	350x350x148	350x350x148	350x350x148
Fans dimensions	mm	120x120x38*4	120x120x38*4	120x120x38*4
Mounting section size	mm	295x295	295x295	295x295

REF700/1400 series cabinet top ventilator

350x350x178mm | 580-1400 m³/h

Colour	RAL7035,color can be customized
Protection category	IP54 standard, IP55 plus precision filter mat, IP56 plus precision filter mat and protective cover.

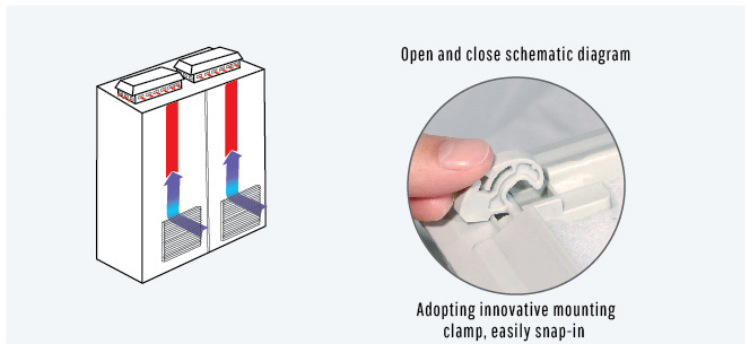

Dimensions

Features:

- Easy and fast snap in mounting that does not require screw
- Adjustable mounting clamps fit for different cabinet thickness range from 1.5 to 3.5mm
- IP54 protection, G3 standard filter pad
- Tool-less and quick replacement of the filter pad, just turn the button on the top
- RAL7035, other colors as per request
- AC voltages as standard type, DC voltages could be offered

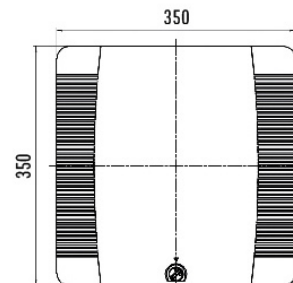
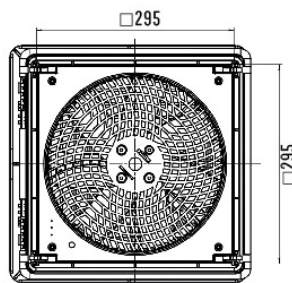
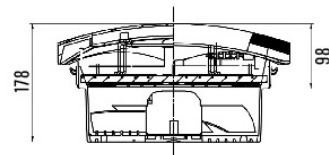

Model No.	unit	REF700.230	REF700.115	REF1400.230	REF1400.115
Rated operating voltage,frequency	V/Hz	230, 50/60	115, 50/60	230, 50/60	115, 50/60
Air flow	m ³ /h	580-700	580-700	1150-1400	1150-1400
Rated current max.	A	0.35-0.28	0.65-0.58	0.60-0.46	0.95-1.20
Centrifugal fan		Capacitor start	Capacitor start	Capacitor start	Capacitor start
Rated Power	W	63-79	61-71	140-100	140-100
Noise level	dB(A)	55-57	55-57	63-65	63-65
Operating temperature range	℃	-30--+70	-30--+70	-30--+70	-30--+70
Dimensions	mm	350x350x178	350x350x178	350x350x178	350x350x178
Fans dimensions	mm	Φ 200	Φ 200	Φ 250	Φ 250
Mounting section size	mm	295x295	295x295	295x295	295x295

KTF series cabinet top ventilator

400x133x400mm | 500-942 m³/h

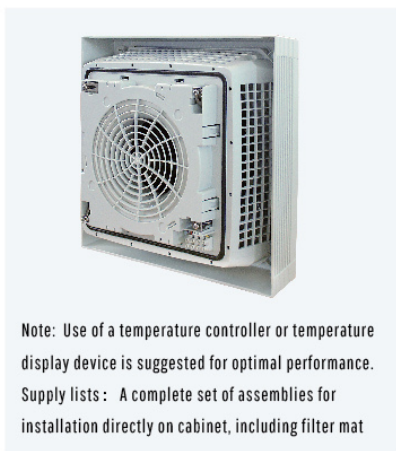

Note: Use of a temperature controller or temperature display device is suggested for optimal performance.
Supply lists: A complete set of assemblies for installation directly on cabinet, including filter mat

Colour	RAL7035,color can be customized
Protection category	IP54 standard, IP55 plus precision filter mat, IP56 plus precision filter mat and protective cover.

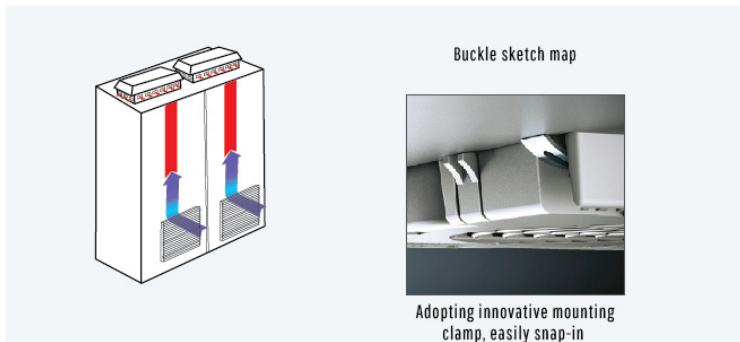

Features:

Easy to fit and maintain

- Innovative mounting clamps enables flexible snap-in the filter fan either from inside or outside of the enclosure
- Easily connecting with power supply via a plug
- Easy maintain, safe and quick replacement of filter pad

color: RAL 7035

Protection class, conform to IEC60529 standard:

without filter mat

with filter mat

Large air throughput range and high efficiency

- Air throughput range: 500-1500m³/h

High protection level

- An exquisite labyrinth construction and super quality polyurethane foam seal ensures the ingress protection rate up to IP55
- International certification and approval

Model No.	unit	KTF3139.230 (115V、400V customizable)	KTF3140.230 (115V、400V customizable)	KTF3141.230 (115V、400V customizable)
Rated voltage	V	230	230	230
Rated frequency	Hz	50/60	50/60	50/60
Phase	ph	1	1	1
Air throughput (without filter mat)	m ³ /h	570-620	873-965	1300-1450
Air throughput (with filter mat)	m ³ /h	456-496	725-759	1050-1180
Rated current	A	0.27-0.22	0.56-0.43	0.99-0.88
Fuse current	A	6	6	6
Motor short circuiter	A	-	-	-
Rated Power	W	62-50	130-98	180-135
Width/Height/Depth	mm	400x133x400	400x133x400	400x133x400
Max.mounting depth	mm	34.6	34.6	34.6
Required mounting section size	mm	258x258	258x258	258x258
Fan type		Centrifugal, capacitor motor		
Operating temperature range	°C	-30~+55		
Storage temperature range	°C	-40~+70		

KRF series cabinet top ventilator

366x366x98mm | 620-1410 m³/h



Colour	RAL7035,color can be customized
Protection category	IP54 standard, IP55 plus precision filter mat, IP56 plus precision filter mat and protective cover.

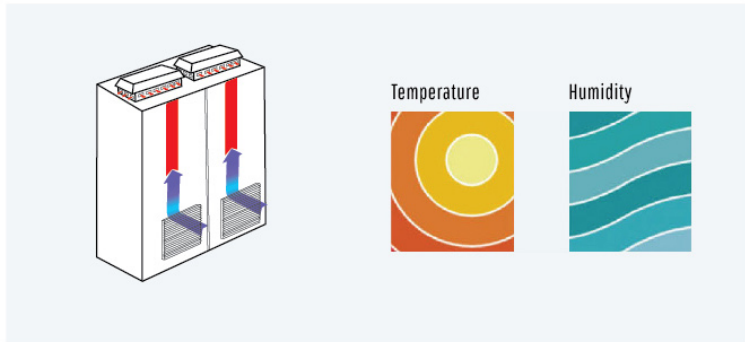

Technical explanation:

The premise of using top-mounted fan:

Ambient temperature should be lower than the temperature that is required to be in the switchboard. Taking top-mounted fan into account when there isn't enough space for a side-mounted filter fan in the cabinet.

Top-mounted fan of the cabinet will bleed the air from the top of the cabinet and drive the heat out so as to protect the electric apparatus and keep them running at the temperature within controllable range. And the structure is more proper because it won't take up space in the cabinet.

EN 60529/10.91 reaches IP54. The retractable high-power centrifugal fan is able to prevent moisture as well as mechanical damage, with its labyrinth rain-proof structure, which with the help of the sealing frame, can reach an IP code up to IP54 as per EN 60 529/10.91. The centrifugal fan is mainly useful for discharge of high-heat load at peak efficiency. Adoption of the centrifugal fan will be able to reduce the noise resulting from air friction as well as avoiding the vortex discharged by normal shaded pole fan.



Using LK33 or EF series Exit Filters at the side of the cabinet not only can prevent water and dust entering the cabinet, also make the air through the whole cabinet for cooling.

Dimensions

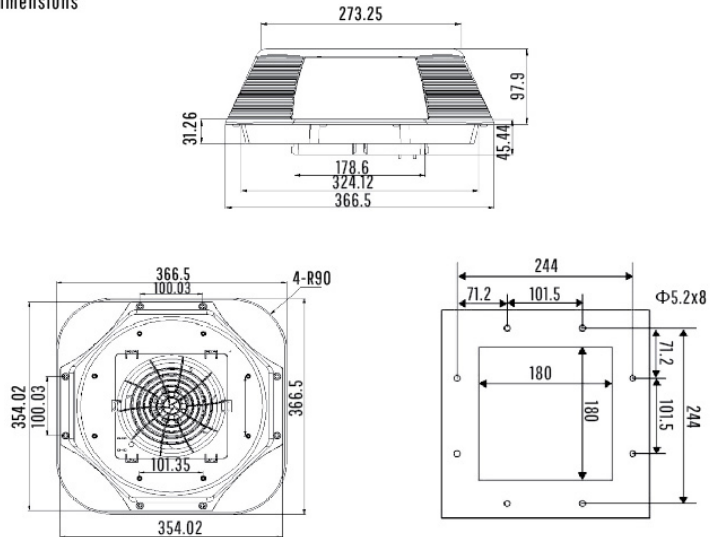

Model	unit	KRF-670	KRF-950	KRF-1410
Rated voltage	V	230	230	230
Rated frequency	Hz	50/60	50/60	50/60
Air flow	m³/h	620	910	1250
free discharge of air	m³/h	670	950	1410
Centrifugal fan		Capacitor start	Capacitor start	Capacitor start
Rated current	A	0.31-0.24	0.38-0.36	0.62-0.58
Rated Power	W	72-56	88-82	190-130
Noise level	dB(A)	55-56	60-62	65-70
Operating temperature range	°C	-10-+55	-10-+55	-10-+55

The quantity and size of the air inlet filter meet the requirements of particular users

F2E series cabinet top ventilator

310x310x130mm | 570-1340 m³/h



Colour	RAL7035, color can be customized
Protection category	IP54 standard, IP55 plus precision filter mat, IP56 plus precision filter mat and protective cover.

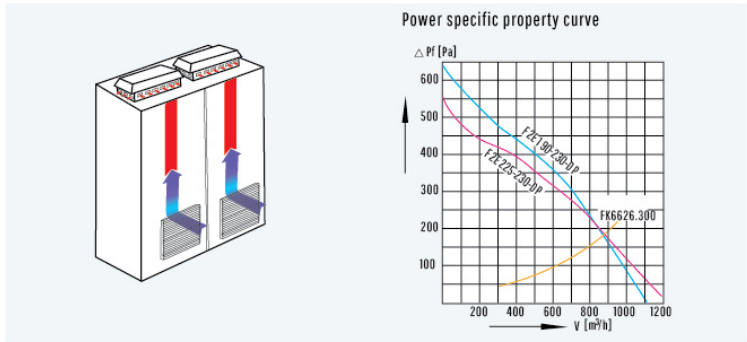

Dimensions

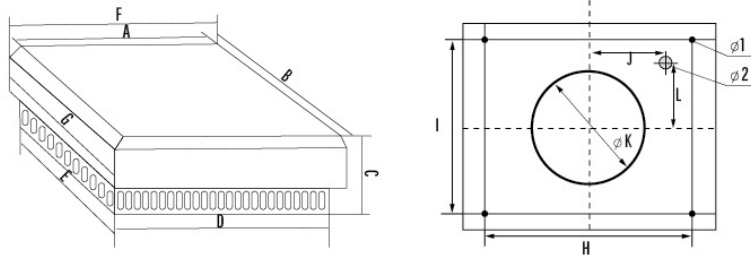

Interior

The precondition to use the top fan is that the ambient temperature should be lower than the temperature required in the cabinet.

Function

The high-power centrifugal top fan can vent the high heat load by the greatest degree. The centrifugal fan not only can avoid the vortex vented by the general shield magnetic fan, but also can reduce the noise caused by the friction of air. The FK series of Exit Filter can be used in the inlet in order to prevent from entering the humidity and dust.

Type	A/B	C	D/E	F/G	H/I	J	Φ K	Φ 1	Φ 2	L
F2E190-230-DP	270	130	267	310	226.8	98.4	195	7.8	15	97
F2E 220-230-DP	270	130	267	310	226.8	98.4	195	7.8	15	97
F2E 225-230-DP	270	130	267	310	226.8	98.4	195	7.8	15	97

Model	unit	F2E190-230-DP	F2E220-230-DP	F2E225-230-DP
Rated voltage	V	230	230	230
Rated frequency	Hz	50/60	50/60	50/60
Air flow, Ventilation freely	m ³ /h	570-620	860-900	1200-1340
Flux of air equip filter exported Include filtering pad of standard	m ³ /h	1xFK6626.300 456-496	1xFK6626.300 688-540	1xFK6626.300 960-1072
Axle flow blower		capacitance electromotion	capacitance electromotion	capacitance electromotion
Rated current	A	0.34-0.26	0.40-0.38	0.88-0.60
Rated Power	W	75-58	90-85	200-135
Noise level	dB(A)	62-64	73-74	69-71
Operating temperature range	°C	-10-+55	-10-+55	-10-+60

The quantity and size of the wind inlet filter can be decided according to the concrete requirement